

TENSION LINK SCALE



Tension Link System is designed as a stable, reliable and high accuracy scale to measure the force in your tension line. This scale system can withstand harsh environments and is suitable for tension applications like hanging crane scales, lifting systems and winching. There are openings on both ends of the alloy steel load cell which allow you to connect hooks, shackles, wire ropes, or whatever your rigging needs may be. Our scale is available in capacities ranging from 10,000-200,000 lbs.



Capacity	Weight
25,000 lbs x 10 lbs	27 lbs
50,000 lbs x 20 lbs	33 lbs
100,000 lbs x 50 lbs	46 lbs
150,000 lbs x 75 lbs	60 lbs
200,000 lbs x 100 lbs	95 lbs
250,000 lbs x 100 lbs	100 lbs

FEATURES:

- Cost effective solution for processing, monitoring and controlling overhead loads
- Used with shackles to measure force
- Designed to measure high capacity loads for cranes, hoists and winches
- Alloy steel constructed load cell
- Includes LED or LCD T-901 Indicator
- Large display indicator with rechargeable battery (up to 100 hrs)
- Selectable weighing units: lb and kg
- 26' load cell cable (longer options available)

WIRELESS VERSION AVAILABLE



PERFECT FOR CRANES, HOISTS, AND WINCHES AND IDEAL FOR WEIGHING WHEN STANDARD LOAD CELL CABLES CAN BE DAMAGED OR UNREACHABLE.

DIMENSIONS

SCALE 25K lbs to 250K lbs

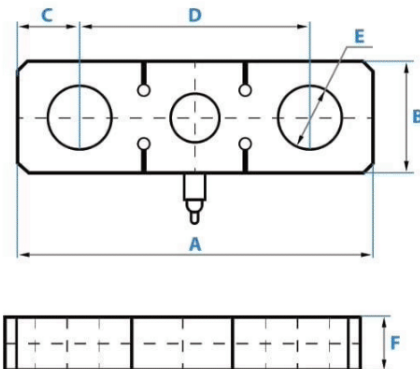

RATED CAPACITY	DIMENSIONS					
	A	B	C	D	E	F
LB/INCHES						
25K lbs	11.15	3.55	7.21	1.97	1.50	1.97
50K lbs	13.53	4.33	8.27	2.01	1.69	2.13
100K lbs	16.55	5.12	11.82	2.81	1.97	2.36
150K lbs	19.70	6.30	13.79	3.15	2.36	2.96
200K lbs	21.67	6.70	14.97	3.80	2.76	3.35
250K lbs	23.64	7.09	15.76	4.02	3.15	3.94
KG/MM						
18,144 kgs	283	90	183	50	38	50
22,680 kgs	318	110	210	51	43	54
45,360 kgs	420	130	300	71.40	50	60
68,040 kgs	500	160	350	80	60	75
90,720 kgs	550	170	380	96.40	70	85
113,400 kgs	600	180	400	102	80	100